

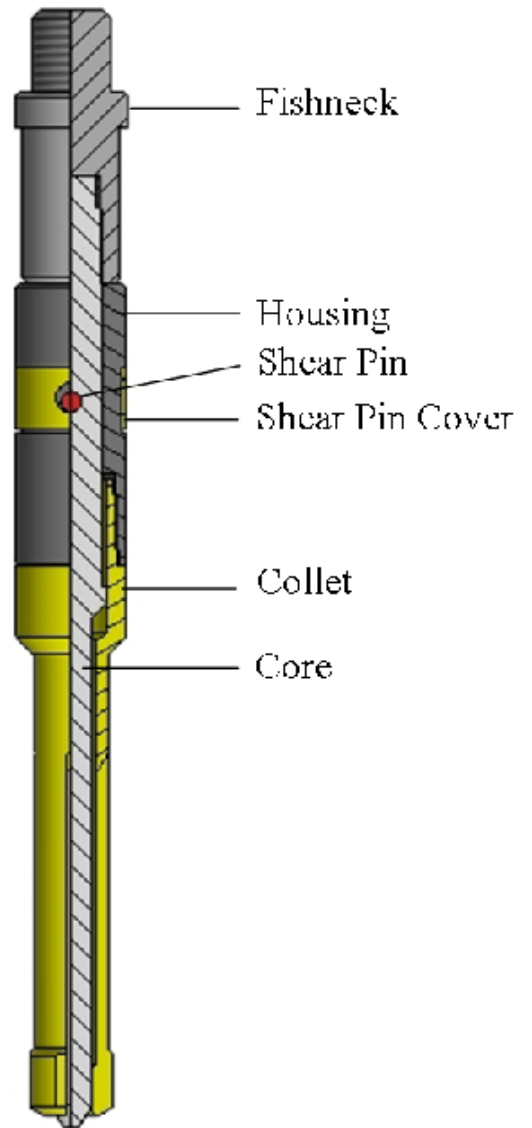

## D RUNNING TOOL

### ASSEMBLY DESCRIPTION

The Type O D Running Tool is used to set the D Lock and DD Bridge Plug.





## D RUNNING TOOL

SPECIFICATIONS			
	2.000	2.500	3.000
Fishneck	1.375	1.750	1.750
Maximum O.D.	1.340	1.750	2.125
Connections	15/16"-10	15/16"-10	15/16"-10
Made Up Length	12.500	12.906	12.875
Shear Pin	1/4" X 1-3/16"	1/4" X 1-5/8"	1/4" X 2"
Set Screw	1/4"-20 X 1/4"	1/4"-20 X 1/4"	1/4"-20 X 1/4"

All Specification Tables contain approximated dimensions and should be used for reference only.