

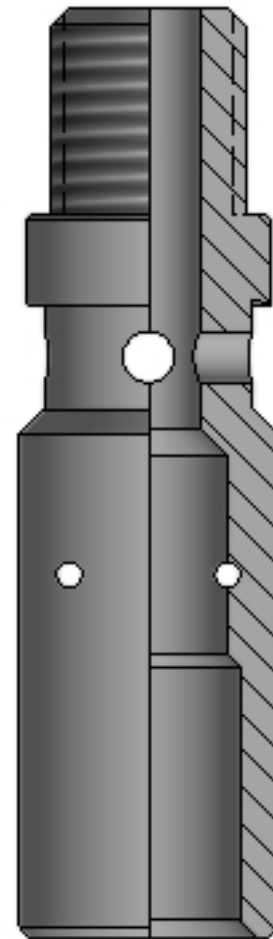

JK RUNNING TOOL

ASSEMBLY DESCRIPTION

The JK Running Tool, is used with a Kickover Tool to install the BK and BK-2 Latches in side pocket mandrels.





JK RUNNING TOOL

SPECIFICATIONS	
	Standard
Fishneck	1.188
Maximum O.D.	1.300
Connections	15/16"-10
Length	3.550
Shear Pin	1/8" X 1-1/8"

All Specification Tables contain approximated dimensions and should be used for reference only.