



## KNUCKLE JOINT

### ASSEMBLY DESCRIPTION

The Knuckle Joint is designed for applications where tool string rotation or deflection is required. It is most useful in fishing applications to properly locate the fishneck.

The Knuckle Joint provides a range of motion that helps to make the connections between the tool string and the running or pulling tools significantly more flexible. If one or more Knuckle Joints are utilized, it will allow for Kickover Tools to explore side pocket areas.

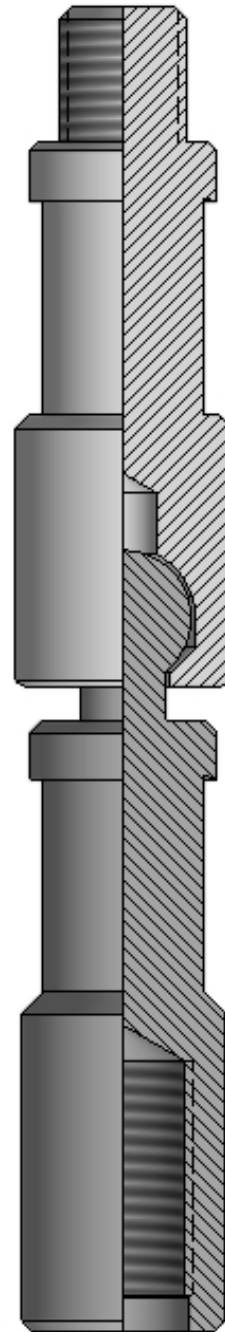



## KNUCKLE JOINT

SPECIFICATIONS				
	.750	1.000	1.250	1.500
Fishneck	0.750	1.000	1.188	1.375
Connections	1/2"-13	5/8"-11	15/16"-10	15/16"-10

SPECIFICATIONS				
	1.750	1.875	2.125	2.500
Fishneck	1.750	1.750	1.750	2.313
Connections	1-1/16"-10	1-1/16"-10	1-1/16"-10	1-9/16"-10

All Specification Tables contain approximated dimensions and should be used for reference only.