



## MULTI-LINE INNER SEAL (DEEP)

### ASSEMBLY DESCRIPTION

Mold #-Line Size-Compound  
1149D-0017-XXXX

When ordering the Deep Multi-Line Inner Seal, use the prefix **1149D** and please specify: line size and compound. Example: 5/16" NBR 80 Duro would be part number **1149D-0017-0808**

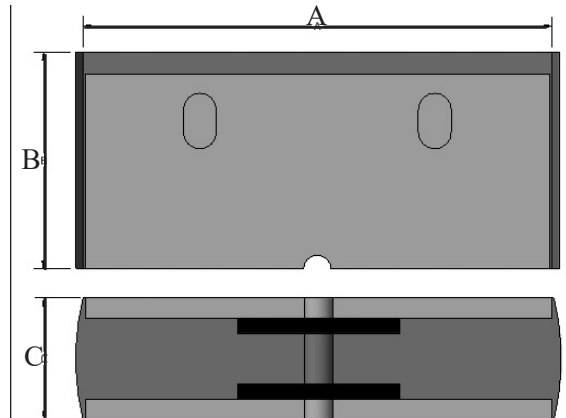

### SPECIFICATIONS

B.O.P. Size	Line Size Part No.	Dim. A	Dim. B	Dim. C	Compound	NBR 80 Duro	HSN 80 Duro	FKM 80 Duro	Epichlorohydrin 80 Duro
5/16"	0017	4.980"	2.370"	1.370"		0808	0848	0708	1308

All Specification Tables contain approximated dimensions and should be used for reference only.