

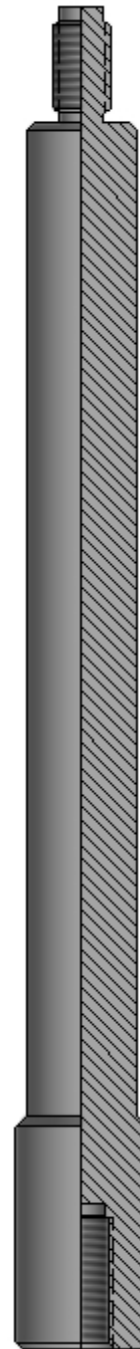

N-1 PROBE

ASSEMBLY DESCRIPTION

The N-1 Probe is used to pull and retrieve Baker Style Equipment, specifically the N, G, L, or R Locks.





N-1 PROBE

SPECIFICATIONS		
	2.000	2.500
Maximum O.D.	0.938	1.235
Connections	1/2"-13	1/2"-13
Length	11.500	11.188

All Specification Tables contain approximated dimensions and should be used for reference only.