



WIRELINE GRAB

ASSEMBLY DESCRIPTION

The Wireline Grab is used to remove damaged wire from the tubing during fishing. This allows the prongs of the Wireline Grab to hook onto the wire. The Wireline Grab is normally run with a dummy Rope Socket.

The customer should specify the following when ordering:

- *The maximum O.D. of the Wireline Grab or the minimum I.D. of the tubing
- *The number of prongs required
- *The connection thread type

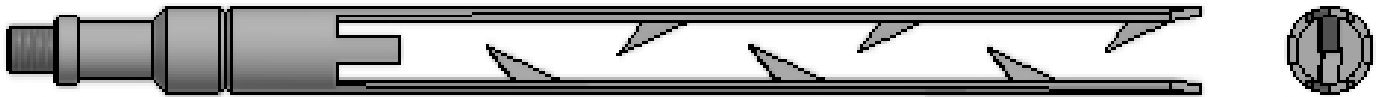

2 PRONG WIRELINE GRAB

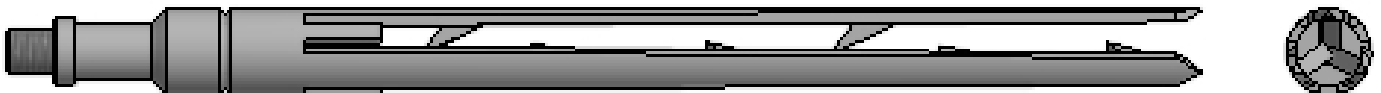

3 PRONG WIRELINE GRAB

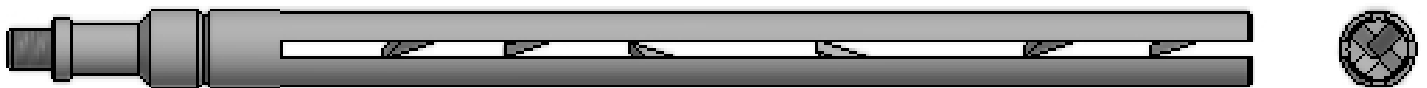

4 PRONG WIRELINE GRAB